



International Beams Inc.
418 rue St. Dizier
Montreal, Quebec H2Y 3P8

Phone: (866) 457-4043

Technical Bulletin (TB-IJ-10)

Subject: Connection of Exterior Deck to IB I-Joist

January 2012

(See page 1 of 2 for background information and detail "IB I-Joist Parallel with Deck Joist")

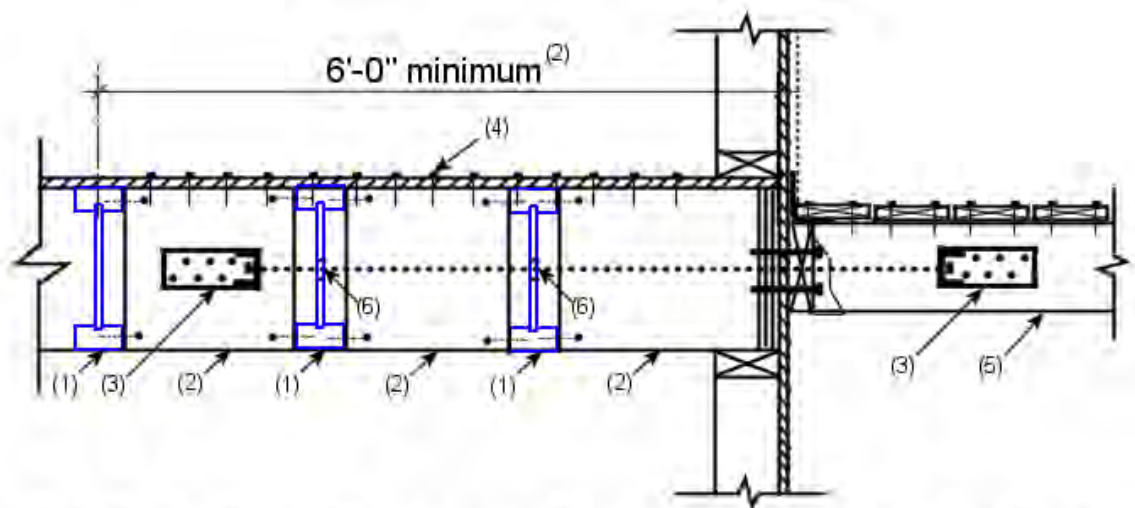

IB I-Joist Perpendicular to Deck Joist (not to scale)

Notes:

- (1) IB (International Beams) I-joist, any depth or series, up to 24" o.c. joist spacing.
- (2) IB LVL blocking, cut to fit between IB I-joists. Install enough blocking to engage a minimum 6'-0" length of subfloor. Cut to allow snug fit and wood-to-wood contact at I-joist flanges, and toenail, or provide other positive anchorage to I-joist flanges. Construction adhesive is recommended to mitigate nail squeak.
- (3) Tension device with minimum 1500# capacity, located at inner-most LVL blocking, installed and fastened as required by device manufacturer for 2x lumber.
- (4) Minimum (16) subfloor nails at LVL blocking where tension device is installed. For existing construction, proprietary connectors fastened to the underside of the subfloor may be used to satisfy this requirement.
- (5) Exterior lumber deck joist. Exterior deck system installation per DCA 6-09, Prescriptive Residential Wood Deck Construction Guide, or engineered design.
- (6) Single 1 1/2" diameter webhole may be located in IB I-joist OSB web at tension rod location (with no restrictions due to existing adjacent webholes).